

P3000-2 Eccentric

Quick Connectors Inc. Well Data Sheet

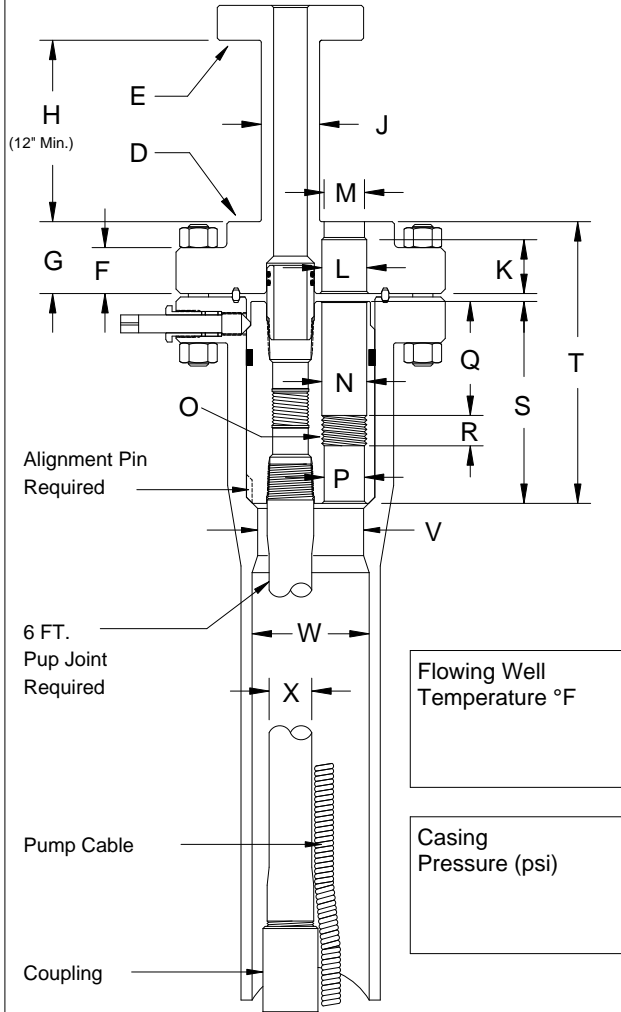
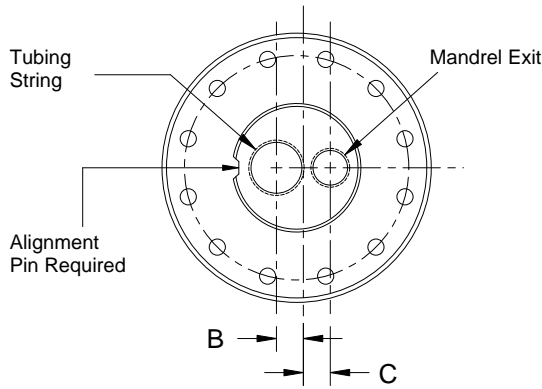

Customer: _____
 Country: _____
 Field: _____
 Well Number: _____
 Wellhead Manufacturer: _____

Well Data Sheet Completed By:	
Company Name	
Employee Name	
Date	

Write Actual Dimensions (Inches)	
B	Tubing Offset From Wellhead Centerline
C	Mandrel Offset From Wellhead Cl.
D	API Flange Size, Specify Whether Flange Is Tapped From Bottom Or Not
E	API Flange Size
F	Thickness Of Adaptor Flange At Studs
G	Maximun Thickness Of Adaptor Flange
H	Distance Between Flange Faces
J	Riser O.D.
K	Depth Of Mandrel Threads (Start)
L	Pocket I.D. Of Adaptor with Tolerance
M	I.D. Above Pocket with Tolerance
N	Hanger I.D. Above Mandrel Threads with Tolerance
O	Thread Description
P	Hanger I.D. Below Mandrel Threads with Tolerance
Q	Depth Of Mandrel Threads (Start)
R	Thread Length
S	Hanger Length (Not Extended Neck)
T	Hanger And Adaptor Penetration (made up)
V	Smallest Bore Through Wellhead
W	Casing Size Nom. I.D.
X	Tubing O.D. Tubing Type

Full Description Of Old Penetrator
With Part Number

Full Description Of Pump Cable

AWG		kV		Round or Flat	
Manufacturer				Solid, Stranded Or Compacted	