

P5000 (Model 2) Eccentric

Quick Connectors Inc. Well Data Sheet

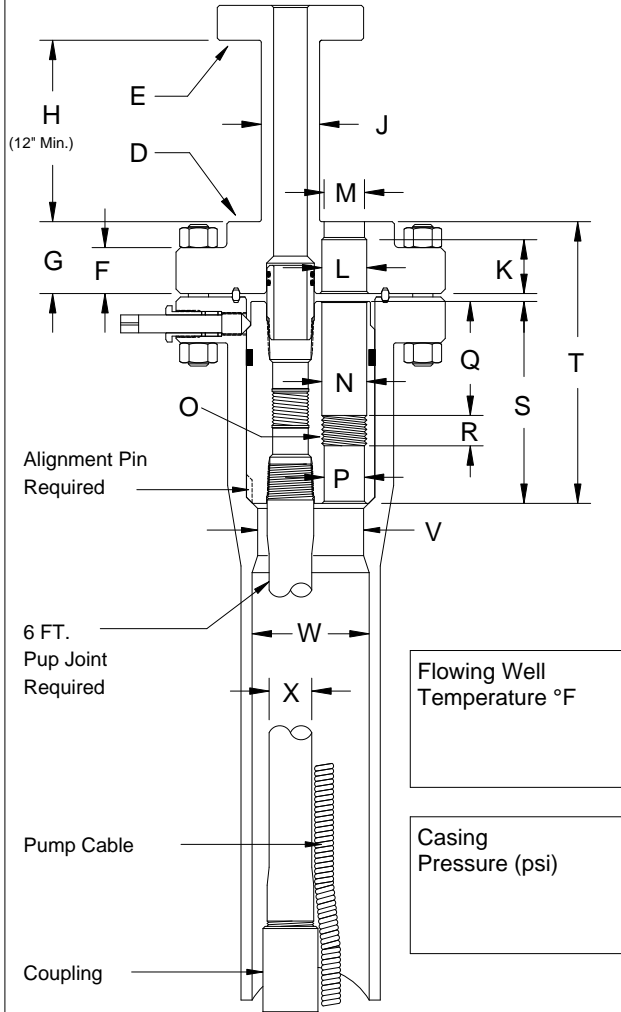
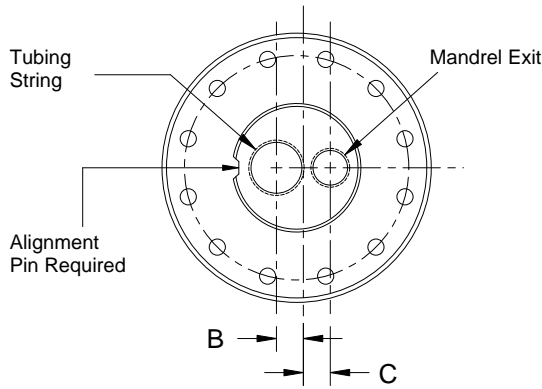

Customer: _____
 Country: _____
 Field: _____
 Well Number: _____
 Wellhead Manufacturer: _____

Well Data Sheet Completed By:	
Company Name	
Employee Name	
Date	

Write Actual Dimensions (Inches)		
B	Tubing Offset From Wellhead Centerline	
C	Mandrel Offset From Wellhead Cl.	
D	API Flange Size, Specify Whether Flange Is Tapped From Bottom Or Not	
E	API Flange Size	
F	Thickness Of Adaptor Flange At Studs	
G	Maximun Thickness Of Adaptor Flange	
H	Distance Between Flange Faces	
J	Riser O.D.	
K	Depth Of Mandrel Threads (Start)	
L	Pocket I.D. Of Adaptor with Tolerance	
M	I.D. Above Pocket with Tolerance	
N	Hanger I.D. Above Mandrel Threads with Tolerance	
O	Thread Description	
P	Hanger I.D. Below Mandrel Threads with Tolerance	
Q	Depth Of Mandrel Threads (Start)	
R	Thread Length	
S	Hanger Length (Not Extended Neck)	
T	Hanger And Adaptor Penetration (made up)	
V	Smallest Bore Through Wellhead	
W	Casing Size Nom. I.D.	
X	Tubing O.D. Tubing Type	

Full Description Of Old Penetrator
With Part Number

Full Description Of Pump Cable

AWG		kV		Round or Flat	
Manufacturer				Solid, Stranded Or Compacted	